

8

7

6

5

4

3

2

1

TECHNICAL DATA	V6105
JAW WIDTH	5.90" (149.86mm)
BASE LENGTH	10.00" (254.00mm)
MAXIMUM TORQUE (JAW BOLT)	35 ft-lb (47.45 Nm)
CLAMPING FORCE	6000 lbf @ 75 ft-lb (26.69kN @ 101.69 Nm)
MAXIMUM TORQUE (LEADSCREW)	75 ft-lb (101.69 Nm)
MAXIMUM TORQUE (MOUNTING BOLT)	35 ft-lb (47.45 Nm)
SELF-CENTERING ACCURACY	± 0.0005" (± 12.7µm)

V6105

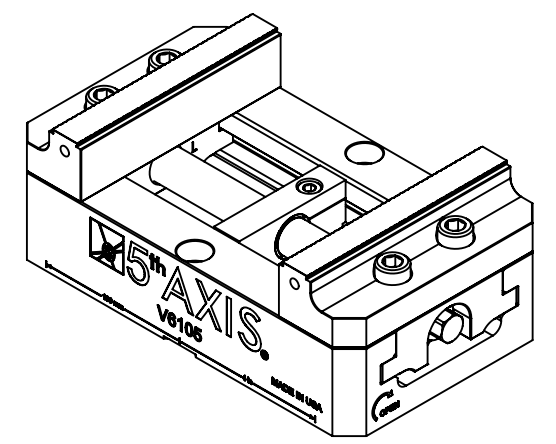

D

D

C

C

B

B

A

A

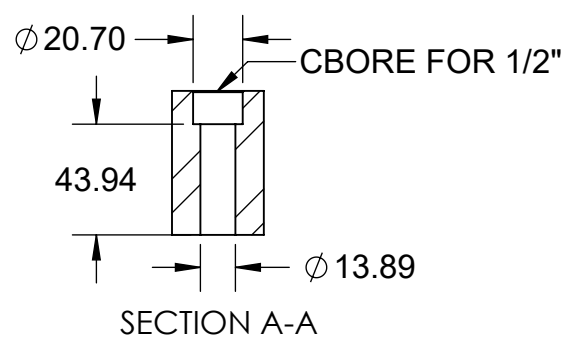
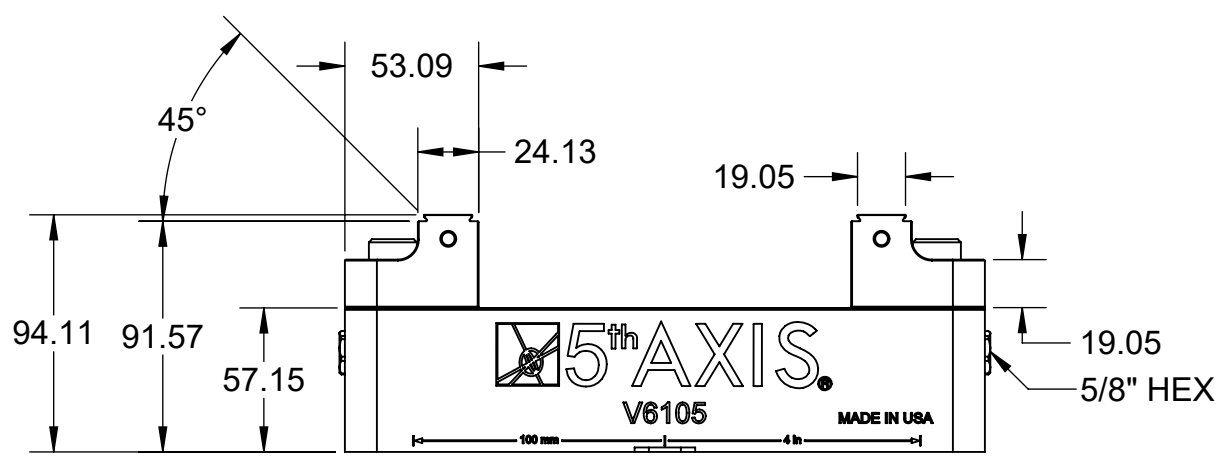
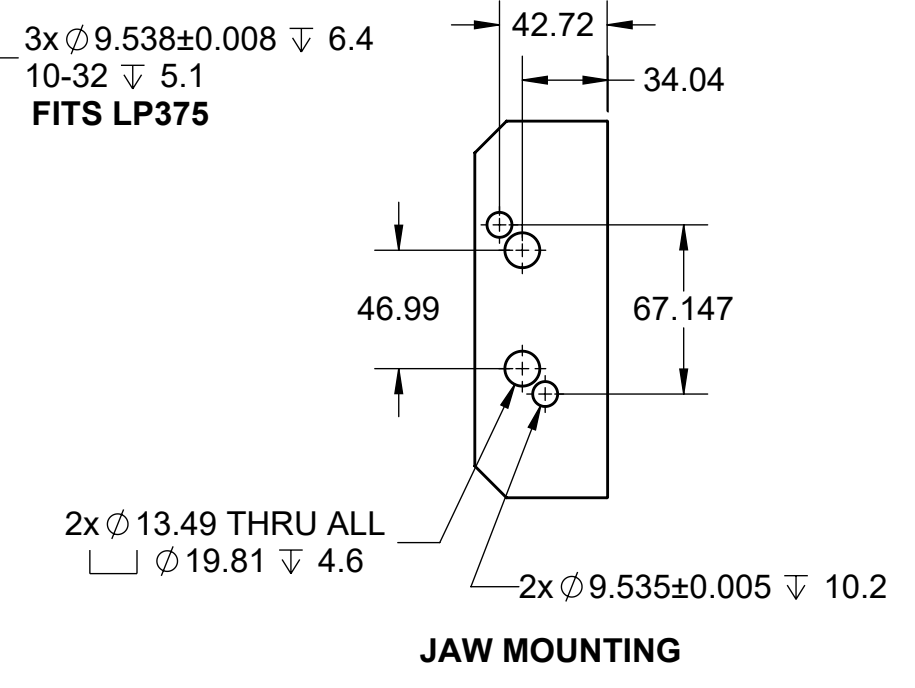
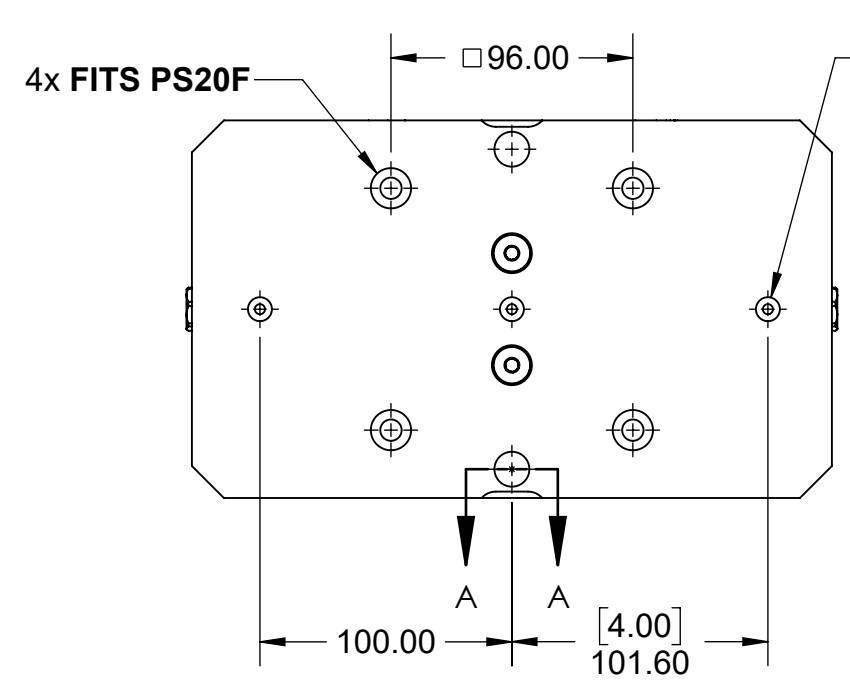
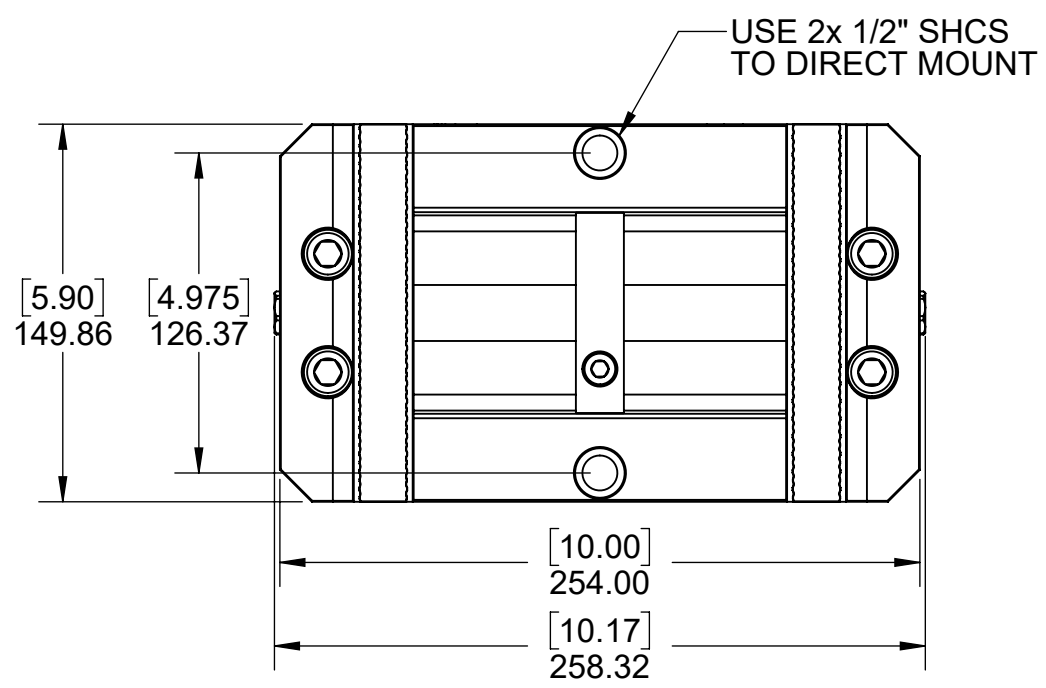

MILLIMETER <small>DRAWN IN ACCORDANCE WITH ASME Y14.5-2009</small> <small>WWW.5THAXIS.COM</small> <small>7140 ENGINEER ROAD SAN DIEGO, CA 92111</small> <small>P (858) 505-0432 F (858) 505-9344</small>	TOLERANCES <small>UNLESS OTHERWISE SPECIFIED</small> x ± 0.1 .xx ± 0.01 .x ± 0.05 .xxx ± 0.005 ANGULAR ± 0.5° <small>THIRD ANGLE PROJECTION</small>			
		DESCRIPTION SELF-CENTERING VISE		
		SIZE B	PART NO. V6105	REV A
DO NOT SCALE DRAWING		SCALE 1:3	WEIGHT:	SHEET 1 OF 3

8

7

6

5

4

3

2

1

8

7

6

5

4

3

2

1

D

D

C

C

B

B

A

A

V6105

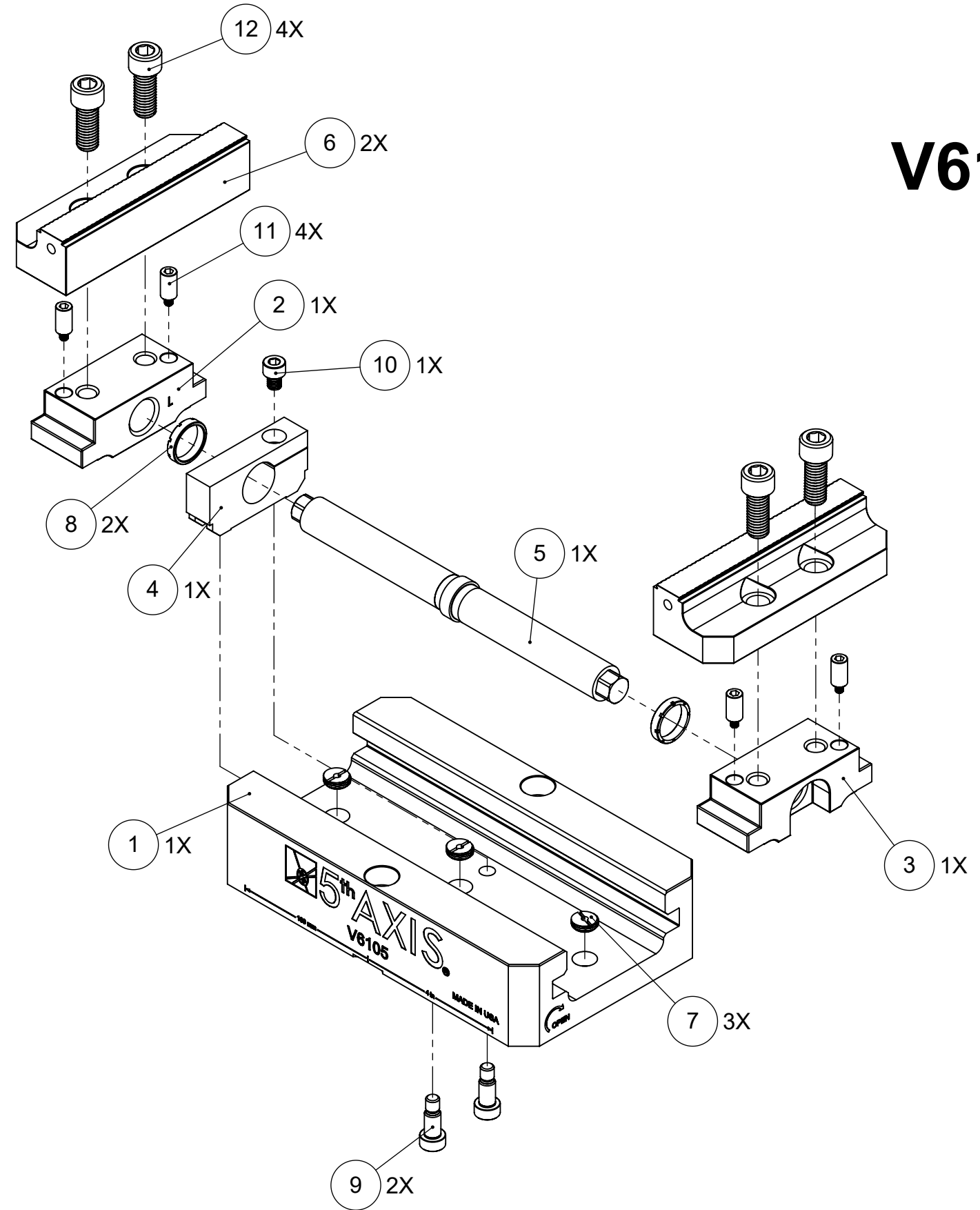

ITEM NO.	PART NUMBER	DESCRIPTION	QTY.
1	V6105-1	BASE	1
2	V6105-2L	LEFT TRUCK	1
3	V6105-2R	RIGHT TRUCK	1
4	V6105MX-3	CENTER BLOCK	1
5	V6105-4	LEAD SCREW	1
6	V6105-5	JAW	2
7	TIS-58	THREADED INSERT	3
8	V6105-6	CENTER BLOCK RING	2
9	SB6VX	SHOULDER BOLT	2
10	91290A414	SOCKET HEAD CAP SCREW	1
11	LP375	LOCATING PIN	4
12	91251A714	SOCKET HEAD CAP SCREW	4
13	ANTI-SEIZE	ANTI-SEIZE (NOT SHOWN)	1
14	LP375	LOCATING PIN (NOT SHOWN)	2
15	TS58	THUMB SCREW (NOT SHOWN)	1

FOR REFERENCE ONLY - NOT FOR RESALE

MILLIMETER <small>DRAWN IN ACCORDANCE WITH ASME Y14.5-2009</small> WWW.5THAXIS.COM 7140 ENGINEER ROAD SAN DIEGO, CA 92111 P (858) 505-0432 F (858) 505-9344	TOLERANCES <small>UNLESS OTHERWISE SPECIFIED</small> x ± 0.1 .xx ± 0.01 .x ± 0.05 .xxx ± 0.005 ANGULAR ± 0.5° THIRD ANGLE PROJECTION			
		DESCRIPTION SELF-CENTERING VISE		
		SIZE B	PART NO. V6105	REV A
		DO NOT SCALE DRAWING	SCALE 1:3	WEIGHT:
		SHEET 2 OF 3		

8

7

6

5

4

3

2

1

8

7

6

5

4

3

2

1

NOTE: USING DOVETAIL ALLOWS VISE TO CLAMP LARGER PART.
BELOW CLAMPING RANGE ONLY SHOWS THE CAPABILITY OF THE GRIPPER TEETH.

V6105

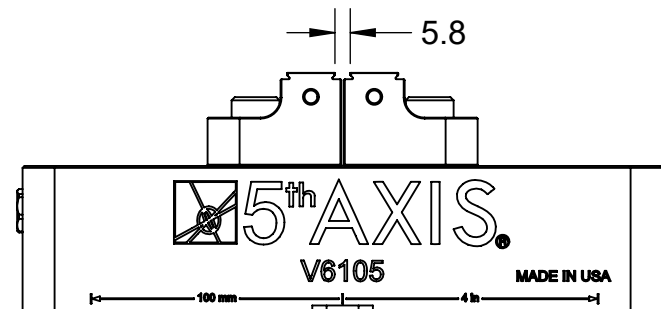

FORWARD JAWS (MINIMUM CLAMPING RANGE)

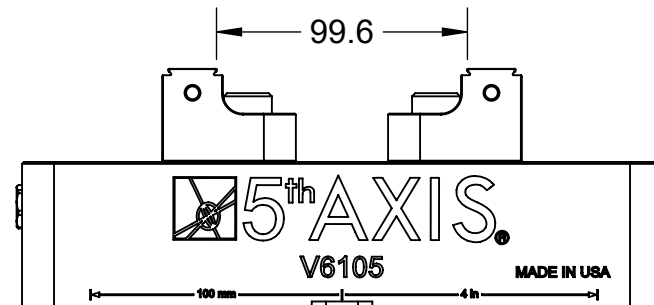

REVERSE JAWS (MINIMUM CLAMPING RANGE)

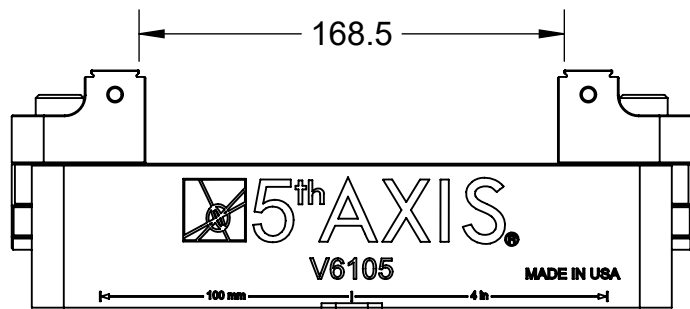

FORWARD JAWS (MAXIMUM CLAMPING RANGE)

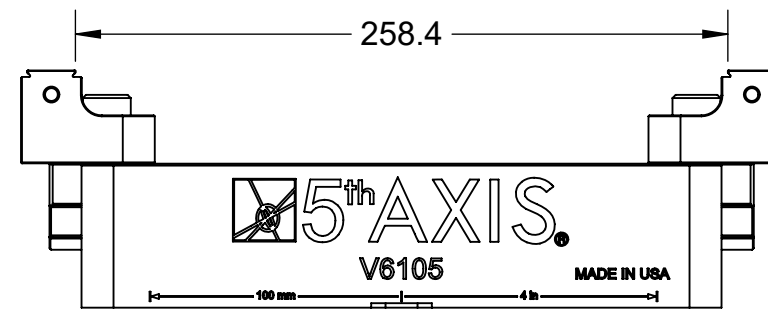

REVERSE JAWS (MAXIMUM CLAMPING RANGE)

MILLIMETER

DRAWN IN ACCORDANCE WITH
ASME Y14.5-2009

WWW.5THAXIS.COM

7140 ENGINEER ROAD
SAN DIEGO, CA 92111

P (858) 505-0432
F (858) 505-9344

TOLERANCES

UNLESS OTHERWISE SPECIFIED

x ± 0.1 .xx ± 0.01
.x ± 0.05 .xxx ± 0.005

ANGULAR ± 0.5°

THIRD ANGLE PROJECTION

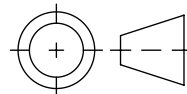

DESCRIPTION

SELF-CENTERING VISE

SIZE
B

PART NO.

V6105

REV
A

DO NOT SCALE DRAWING

SCALE 1:3

WEIGHT:

SHEET 3 OF 3

8

7

6

5

4

3

2

1